

HOTFOOT™

HEAT TRANSFER SYSTEM

BY:

CORRUGATED GEAR AND SERVICES, INC.

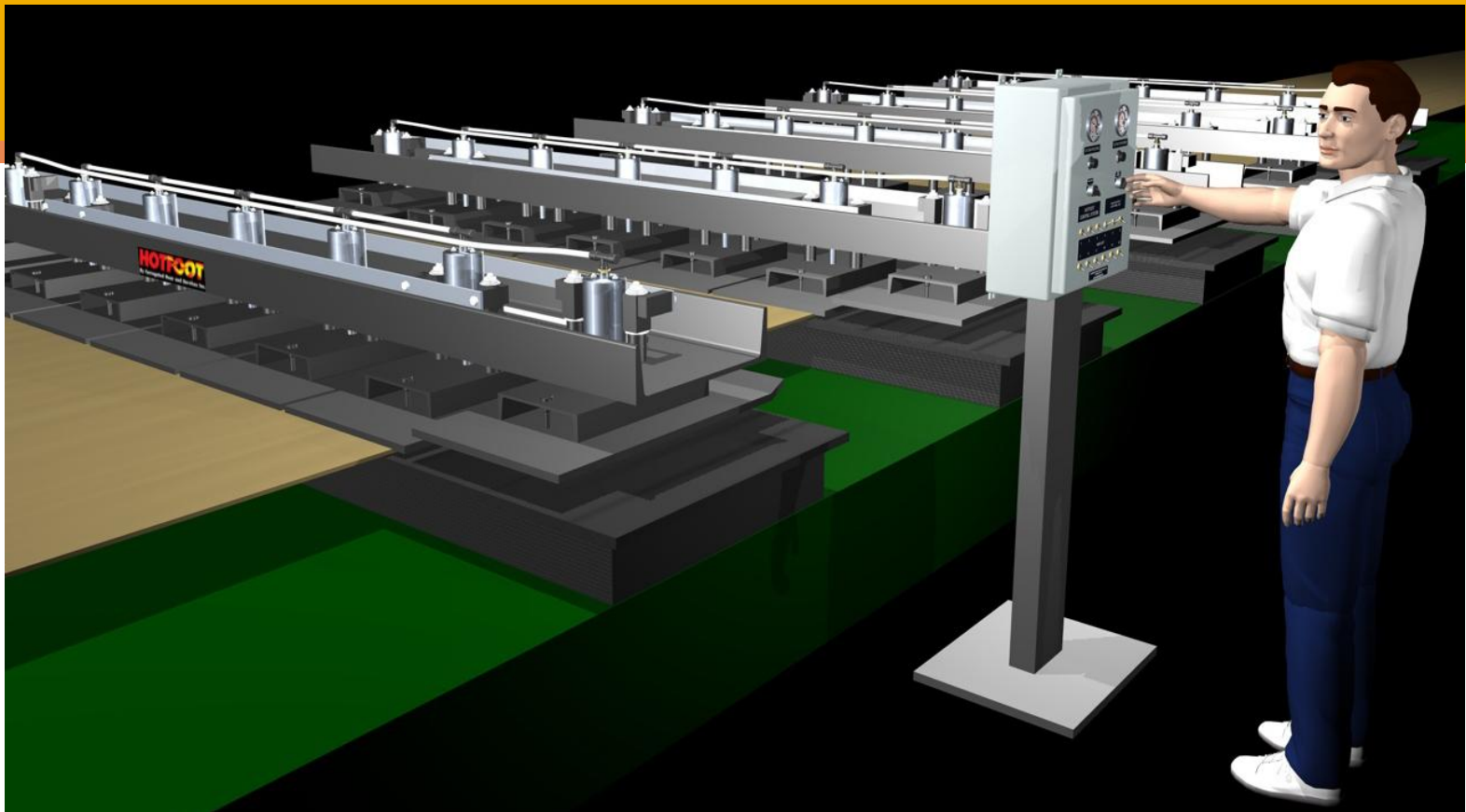

U.S. PATENTS: 5526739, 5711214, 5732622

HOTFOOT™



HOTFOOT™

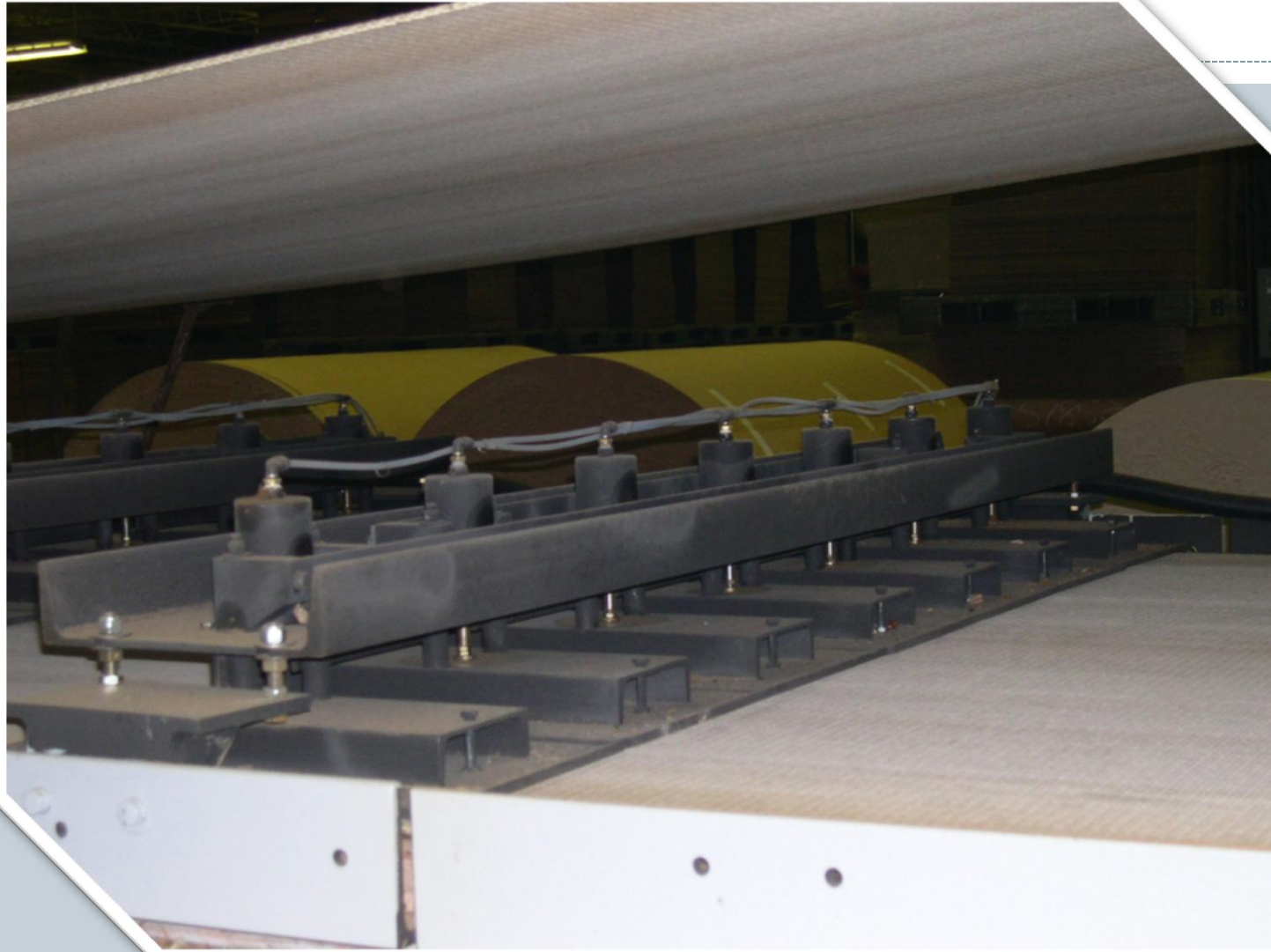

The Dual-Action cylinder maintains constant pressure regardless of board thickness

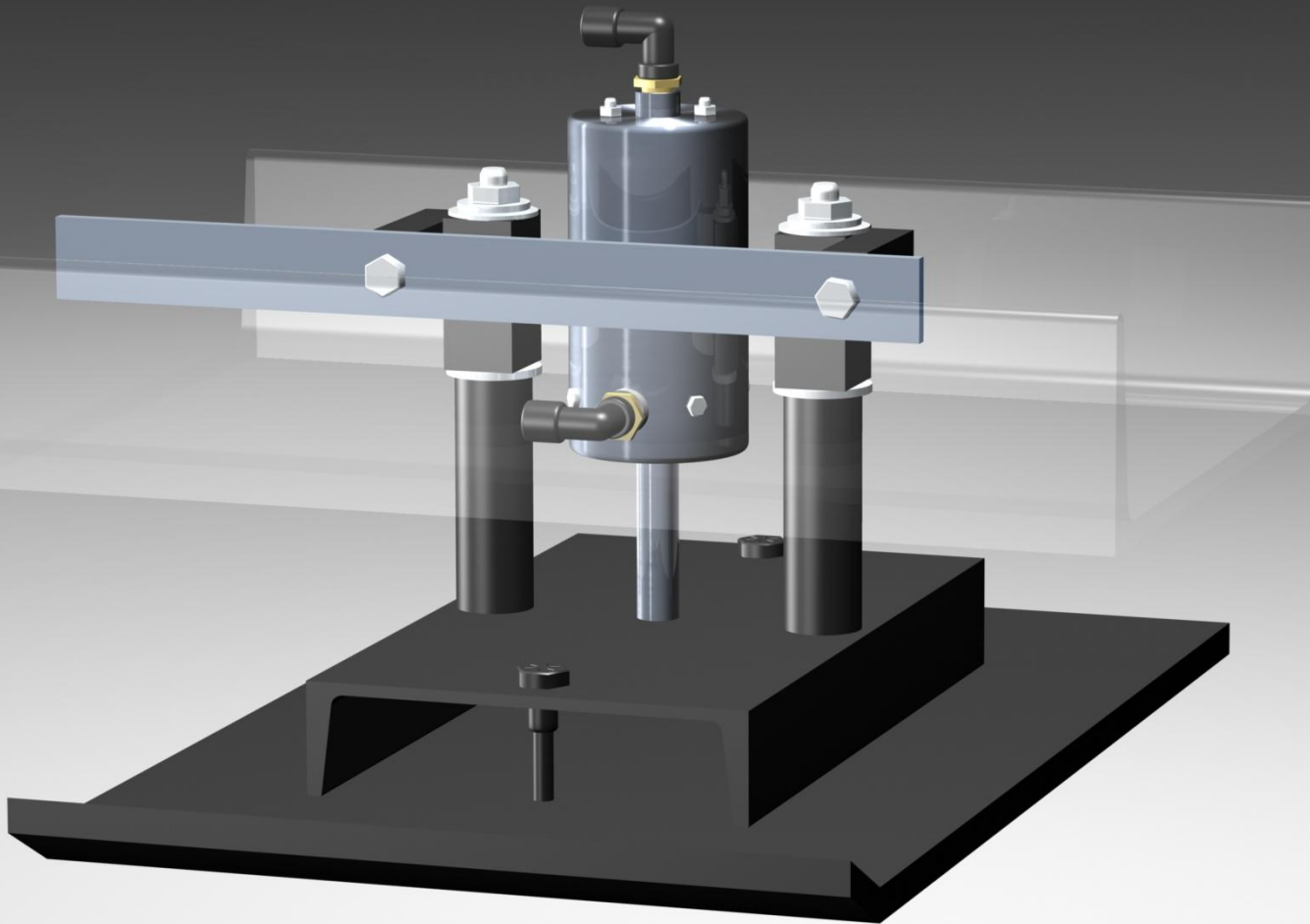

Anti-Tilt Bar

Dual-Action Cylinder
with Hi-Temp
Components

***Reduced Moving Parts
Per Shoe To 4!***

Heavy Duty Precision
Engineered Shoes



Corrugated Gear
AND SERVICES INC.

HOW DOES IT WORK?

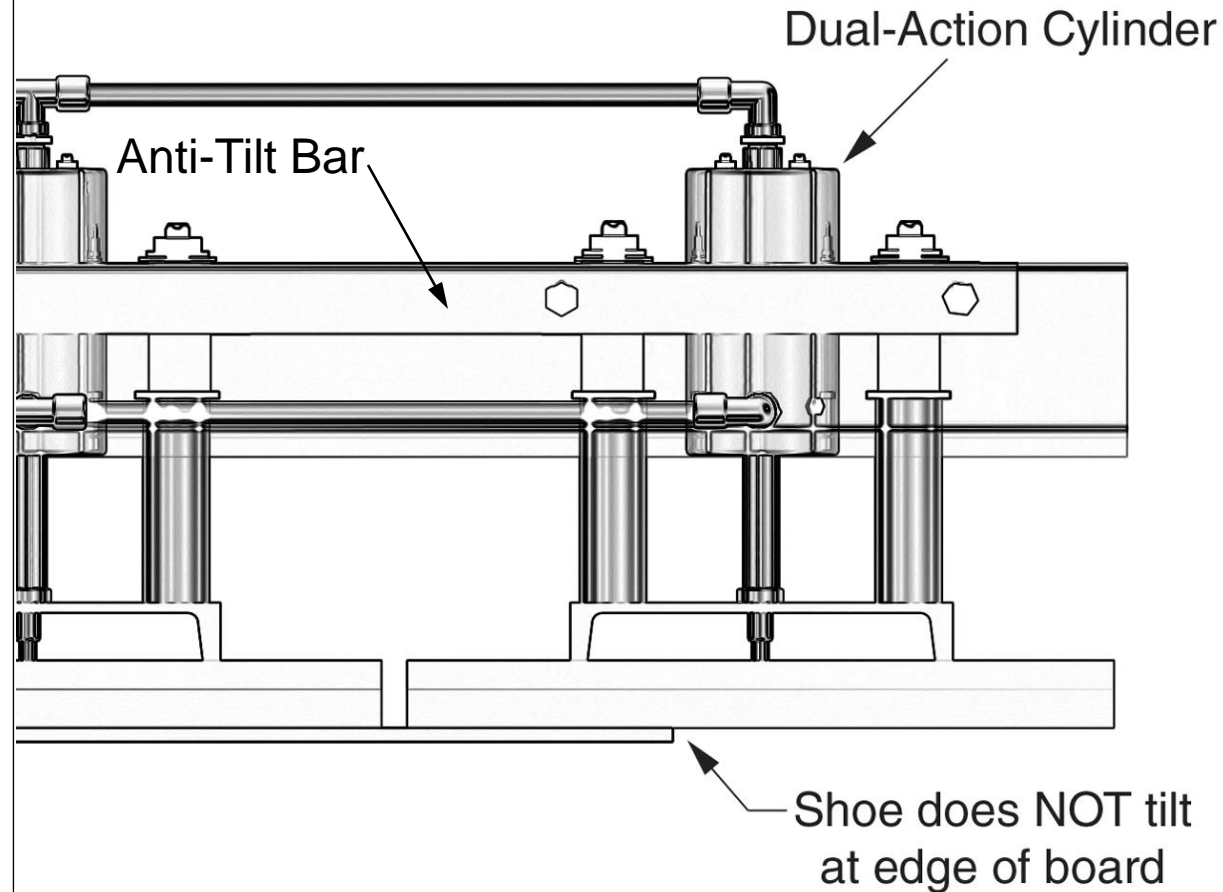

- Anti-tilt feature keeps shoes level – no trapping of heat/moisture at edges (patent pending)
- Each bar can be adjusted either manually or automatically
- Full or partial integration with all popular corrugator control systems available

WEIGHT ROLLER SYSTEMS

WHY DO YOU NEED THE HOTFOOT?

NARROW BOARD WITH WEIGHT ROLLER

(Image exaggerated for clarity)

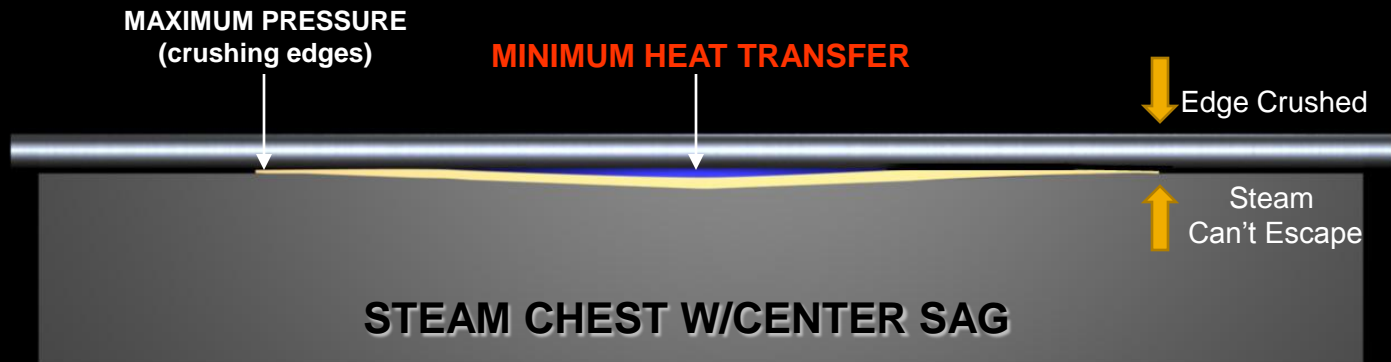



NARROW BOARD WITH HOTFOOT HEAT TRANSFER SYSTEM

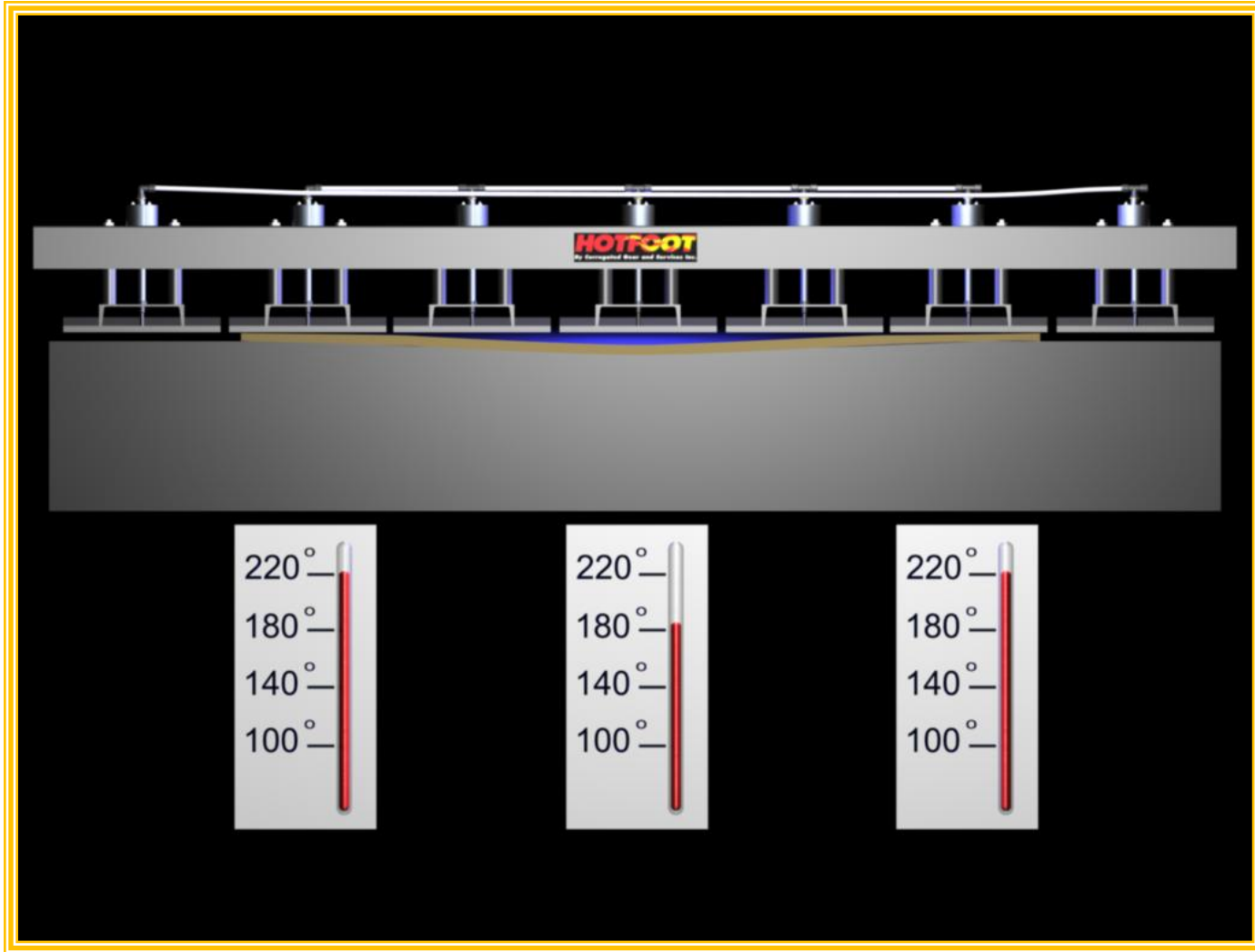



PRESSURE DISTRIBUTION

Normal pressure required for MAXIMUM heat transfer is .14 - .20 P.S.I.

HOTFOOT v/s Weight Roller

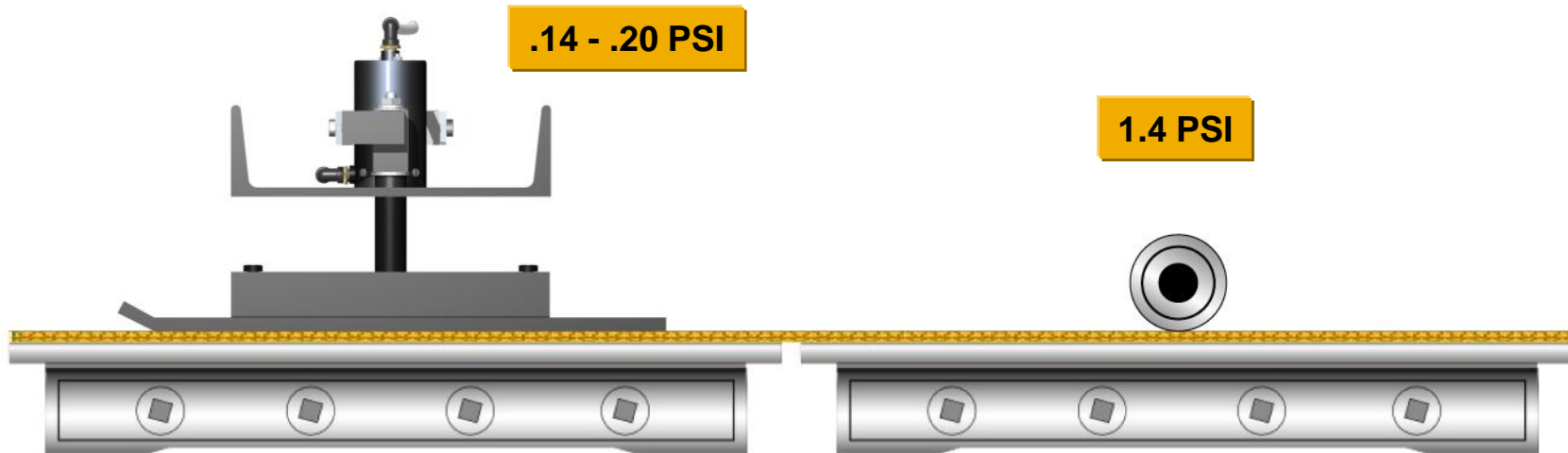

Distributes Optimal Pressure With Greater Coverage Area

FIXED SPRING PRESSURE DEVICES

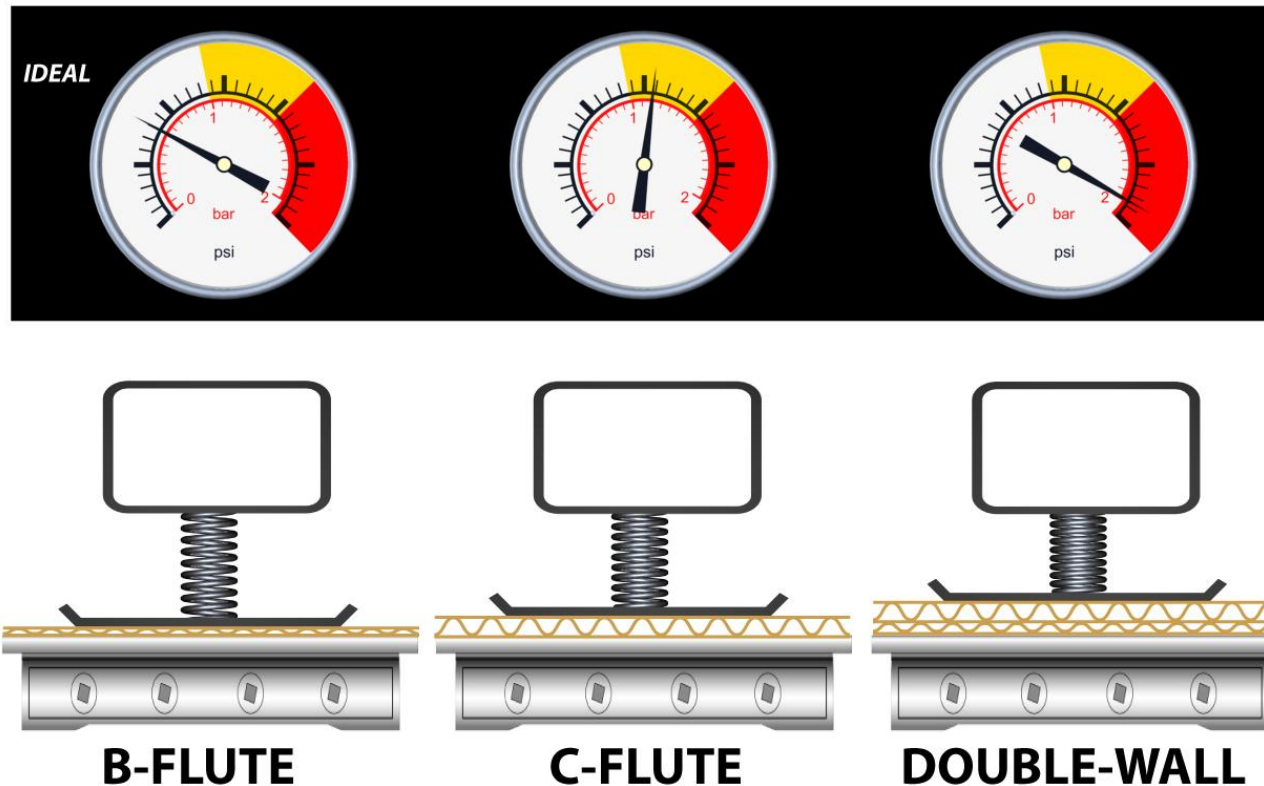

Even if fixed pressure spring-loaded transfer devices are adjusted to exert even pressure across the hotplate, they cannot be easily adjusted to compensate for a difference in board thickness. If the spring-loaded device is adjusted for ideal pressure on B-flute, it will create excessive pressure and drag on C-flute and double-wall.



PRESSURE VS. TEMPERATURE & DRAG

It is very important to maintain the proper pressure on the web, in order to maintain maximum heat transfer, without creating excessive drag. Pressure greater than .3 PSI will cause the double backer drive to draw excessive current and premature belt wear without increased heat transfer. The graph below illustrates this point.

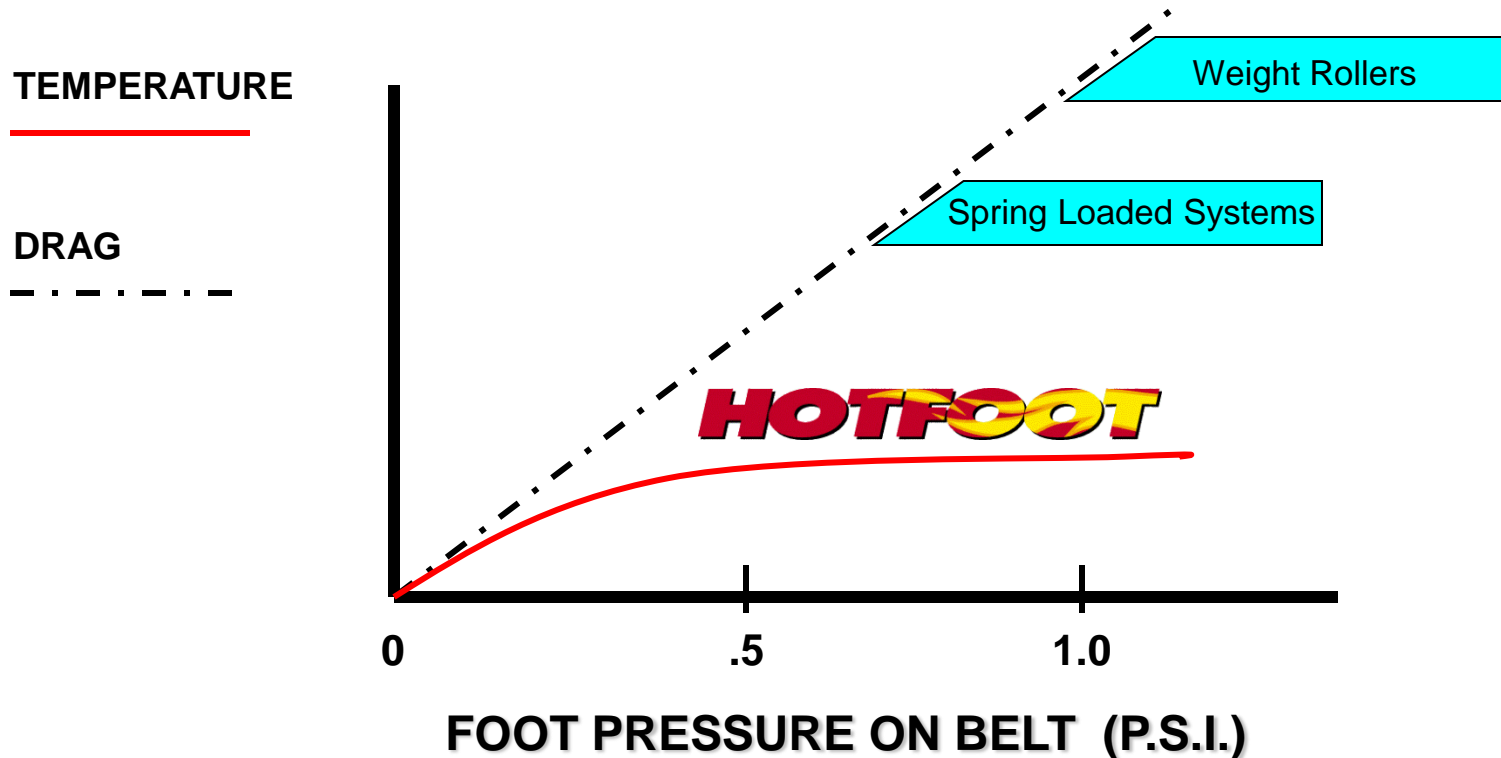

**Simplified controls –
now *standard* on all systems!**

Outer shoe lift

Center shoe over-ride

System pressure

Bar “UP – DOWN”

*No operator changes needed
when changing flutes/grades*



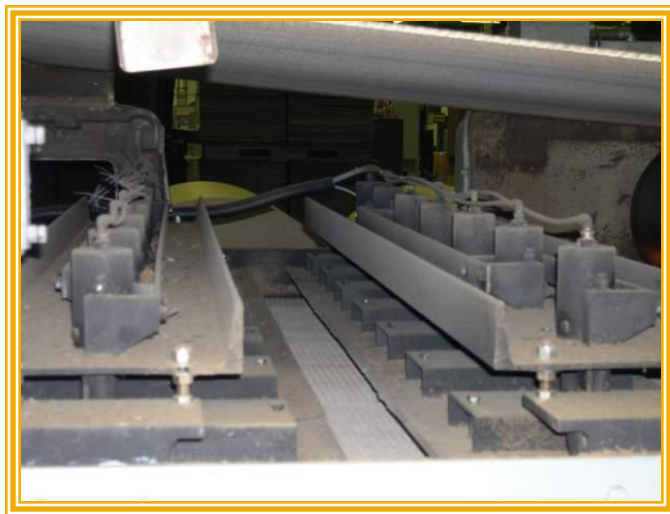

What HOTFOOT does for you!

- Transfers more heat – more evenly.
- Because it's adjustable across the web, edge crush is virtually eliminated.
- HOTFOOT™ compensates automatically for “highs”, “lows”, and the continuous changes to your hot plates.
- Since you use minimal pressure, HOTFOOT™ can result in significant power savings.



HOTFOOT™ Technology for your *Traction Section!*

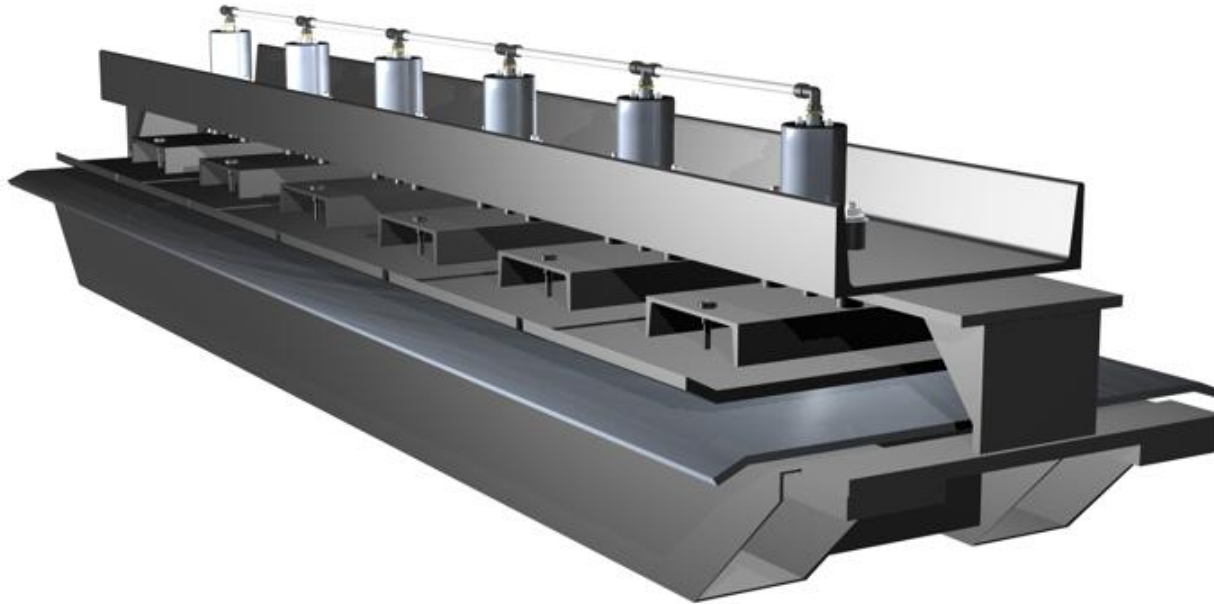

- Now **ADJUSTABLE** pressure for your traction section!
- Stop spending weekends changing out worn rollers and bearings





HOTFOOT²

**Simplicity meets
Affordability with this
“little brother” of the
original HOTFOOT™**

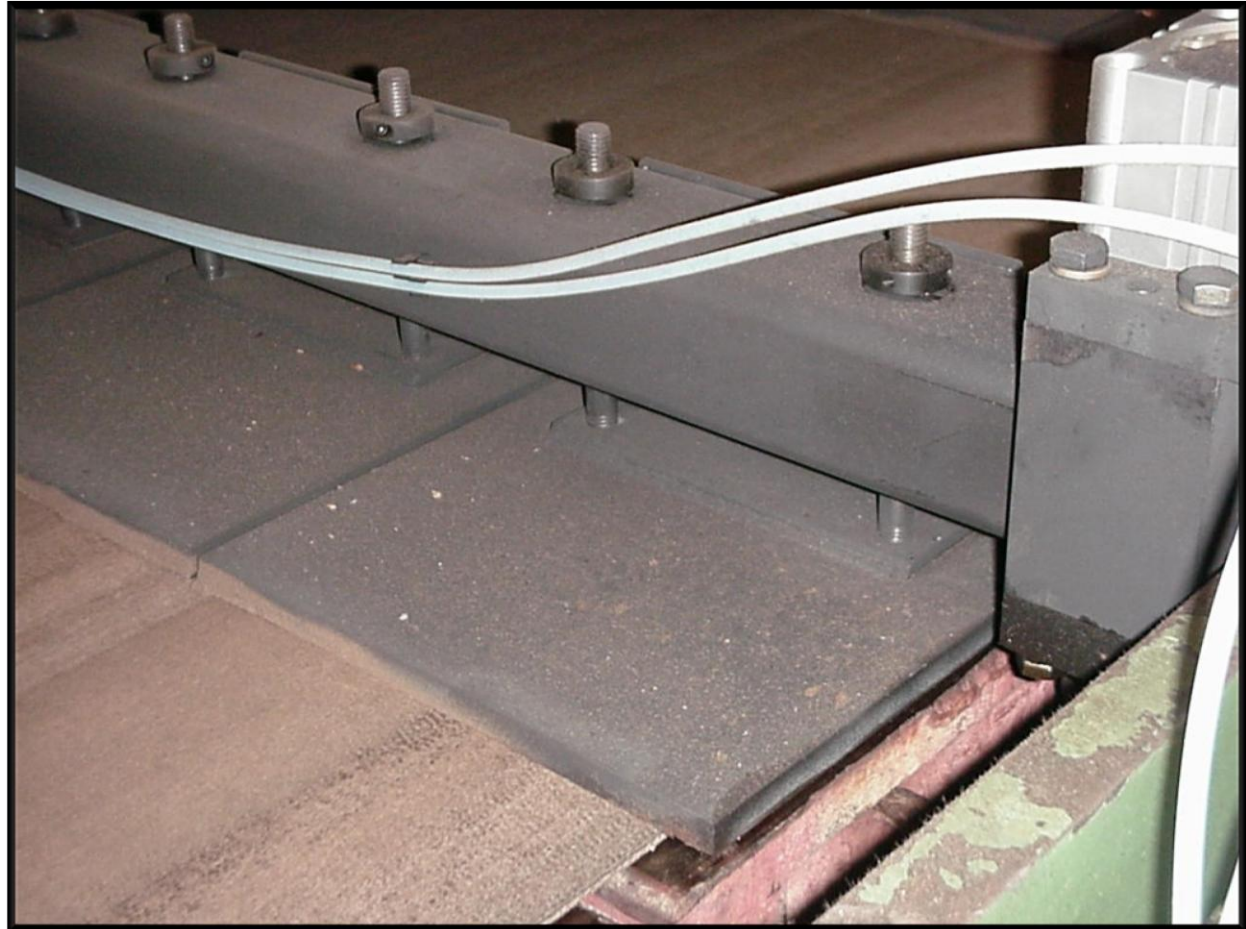



Corrugated Gear
AND SERVICES INC.

HOTFOOT²

•Works with ALL flutes
and grades





Corrugated Gear
AND SERVICES INC.

HOTFOOT²

- Works with ALL flutes and grades

- Consistent, optimal pressure for max. heat transfer

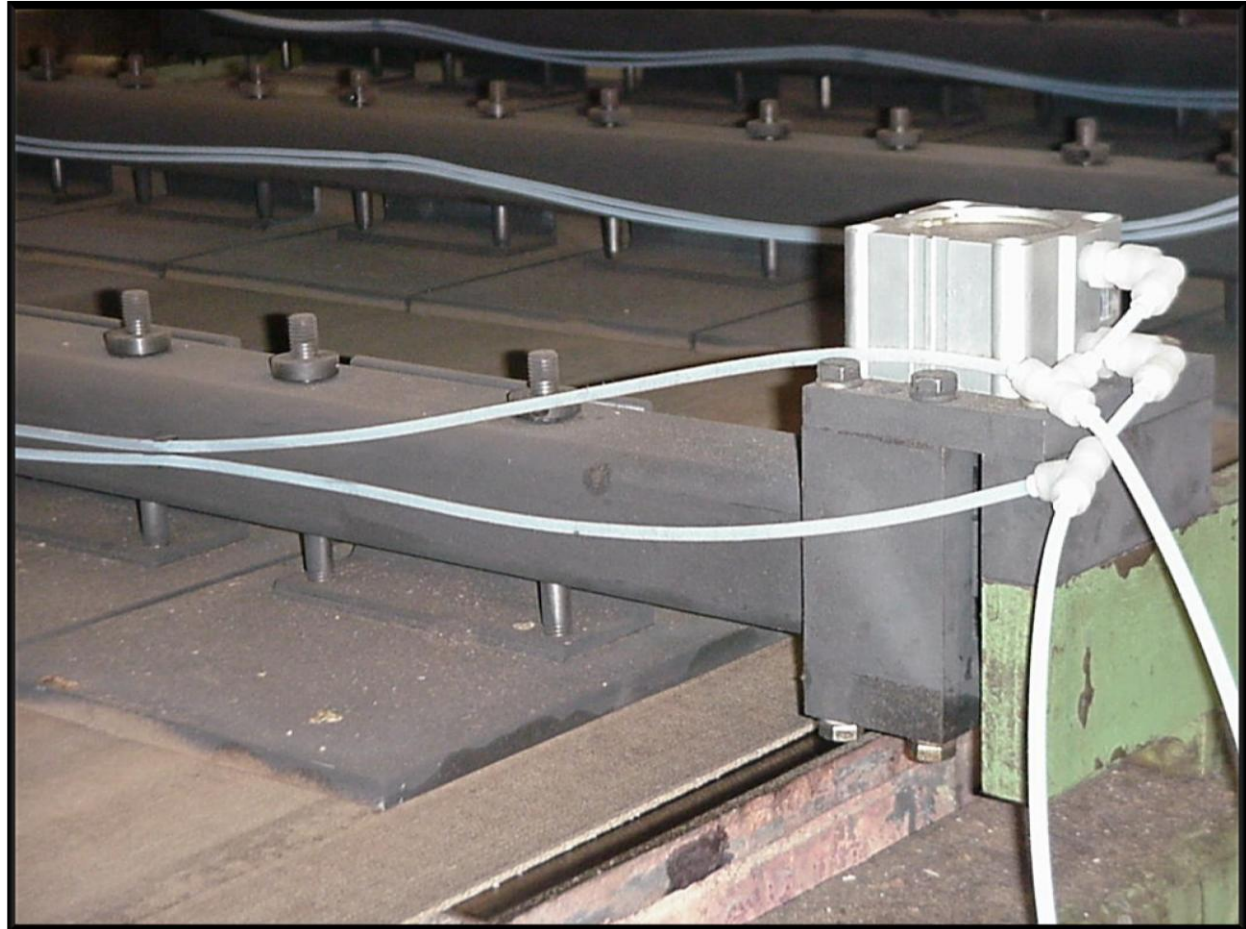



Corrugated Gear
AND SERVICES INC.

HOTFOOT²

- Works with ALL flutes and grades
- Consistent, optimal pressure for max. heat transfer
- “Set It and Forget It” Thermal Logic Technology





Corrugated Gear
AND SERVICES INC.

HOTFOOT²

- Works with ALL flutes and grades
- Consistent, optimal pressure for max. heat transfer
- “Set It and Forget It” Thermal Logic Technology
- Virtually NO operator adjustment required



CONTACT INFORMATION:



Ph: (770) 475-8929 ~ Fax: (770) 442-3371

Email: cgsparts@corrugatedgear.com

Website: www.corrugatedgear.com